





Drawing No	AR/SR/1001	Revision	-	Sheet Size	A1
DO NOT SCALE					

A

B

C

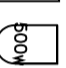
D

-  6WAY SOCKET SPIDER WITH CABLE LENGTH
-  SPEAKER
-  575w SOURCE 4 PAR MED
-  500w HOUSE LIGHT (FLOOD)
-  650w FRESNEL

E

Notes:

F

G

H

Issue	Date	Revision Notes	By
INFORMATION			

Client

ASSEMBLY PRODUCTIONS

Project	EDINBURGH ASSEMBLY ROOMS		
Venue	SUPPER ROOM		
Drawing Title	GENERAL LAYOUT		
Drawing Number	AR/SR/1001	Revision	-
Drawn	GMP	Designed	AS EXG
Checked		Scale	1:50
		Date	07/01/01



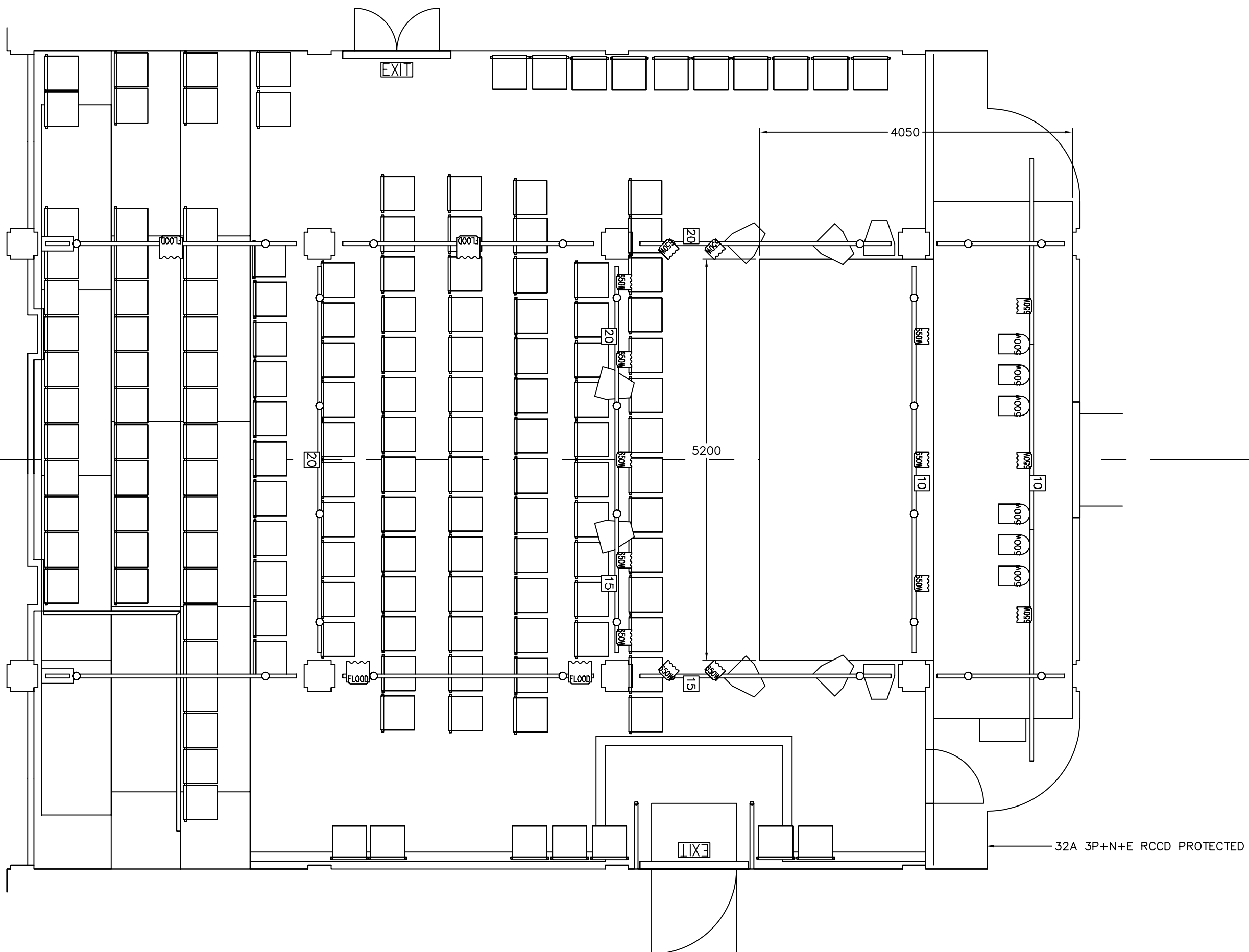

- 20 AWG SOCKET SPIDER WITH CABLE LENGTH
- SPEAKER
- 575w SOURCE 4 PAR MED
- 300w HOUSE LIGHT
- 650w FRESNEL
- BULKHEAD MOUNT EMERGENCY LIGHT
- EMERGENCY EXIT SIGN

Notes:
 LIGHTING GRID:
 CONSTRUCTED FROM #48 SCAFFOLD TUBE.
 POWER:
 32A THREE PHASE WHERE INDICATED.
 SEATING:
 x SEATS POSITIONED WHERE INDICATED.
 ALL AISLES OF 1100mm UNLESS OTHERWISE INDICATED.
 SEATING TIER RISE OF 300mm
 SEATING TIER DEPTH OF 900mm

Issue Date	Revision Notes	By
INFORMATION		
Client ASSEMBLY PRODUCTIONS		
Project EDINBURGH ASSEMBLY ROOMS		
Venue SUPPER ROOM		
Drawing Title VENUE LAYOUT		
Layout Name FIXED LIGHTING		
Drawing Number AR/SR/1002	Revision -	
Drawn GMP	Designed -	
Checked	Scale 1:50	Date 22/07/02

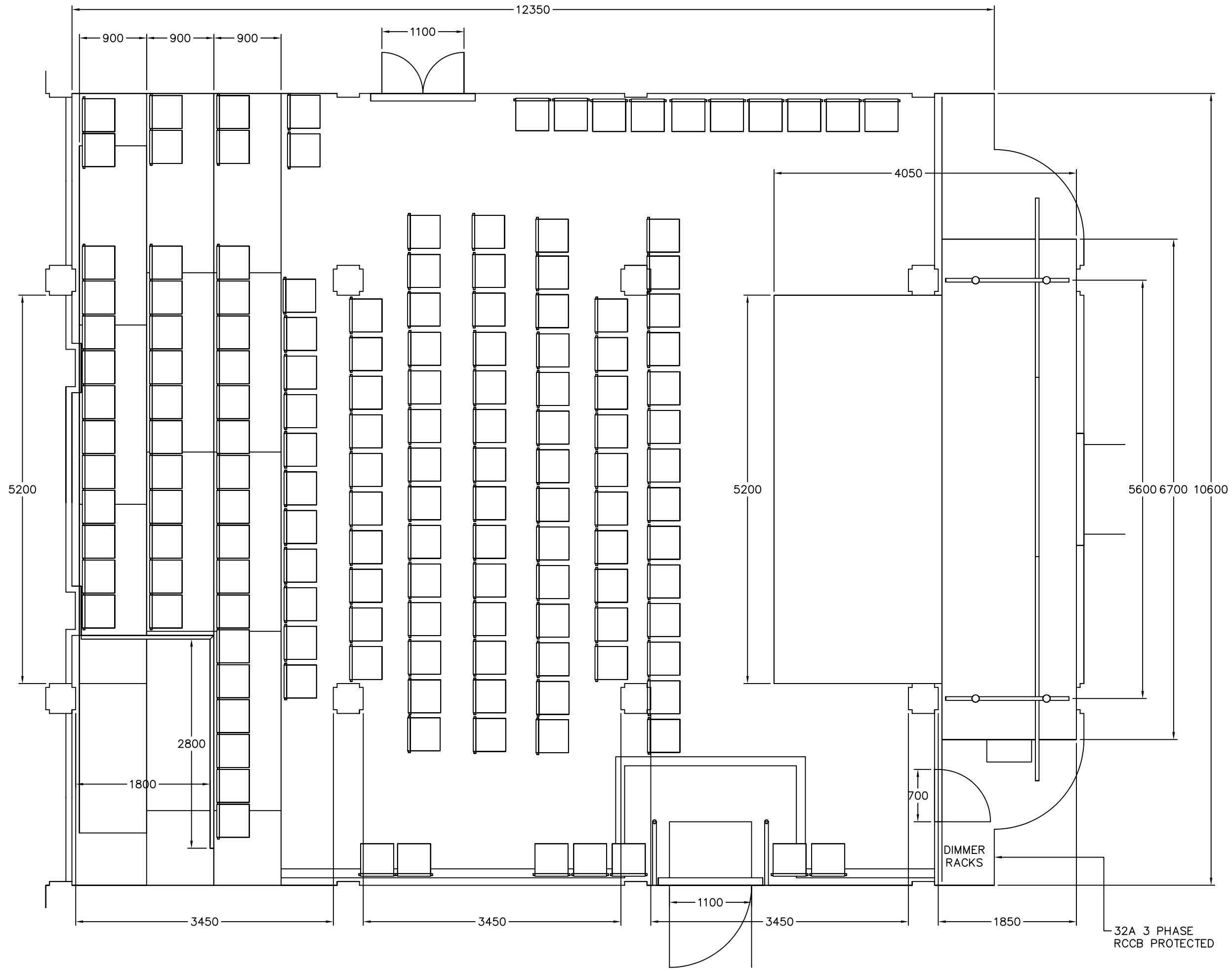

Notes:
 LIGHTING GRID:
 CONSTRUCTED FROM #48 SCAFFOLD TUBE.
 POWER:
 32A THREE PHASE WHERE INDICATED.
 SEATING:
 x SEATS POSITIONED WHERE INDICATED.
 ALL AISLES OF 1100mm UNLESS OTHERWISE INDICATED.
 SEATING TIER RISE OF 300mm
 SEATING TIER DEPTH OF 900mm

Issue Date	Revision Notes	By
INFORMATION		
Client: ASSEMBLY PRODUCTIONS		
Project: EDINBURGH ASSEMBLY ROOMS		
Venue: SUPPER ROOM		
Drawing Title: VENUE LAYOUT		
Layout Name: STAGE LAYOUT		
Drawing Number: AR/SR/1003	Revision: -	
Drawn: GMP	Designed: -	
Checked:	Scale: 1:50	
	Date: 22/07/02	